

DEK CAD automatically provides the designs, the list of items with weights and volumes, totals and individual pashas of the project.

It is easy to use even for users with basic technical knowledge, the software is useful for:

- **technical departments of manufacturers:** estimates, design, training;
- **renters and business:** estimates and inventory management, planning, cost control, handling;

The designer, guided by masks, indicate the rules of use of the formworks on the plan, so the software will automatically positioning the one with all the accessories.

For intricate details, the designer has the complete freedom and can manually modify the project using all the commands of the CAD to have a complete and real design.

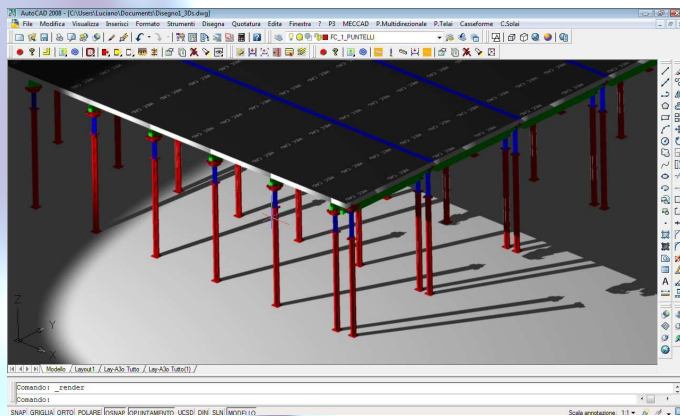

MEC CAD Suite

DEK CAD is a part of a suite of application dedicated to the management of construction equipment:

- **FOR CAD walls formwork**
- **PON CAD scaffolding 3D**
- **P3 scaffolding 2D**
- **MEC WEB Internet configurator**

All the software can be used simultaneously in the same draw to make estimates and complete projects of scaffolding and formwork.

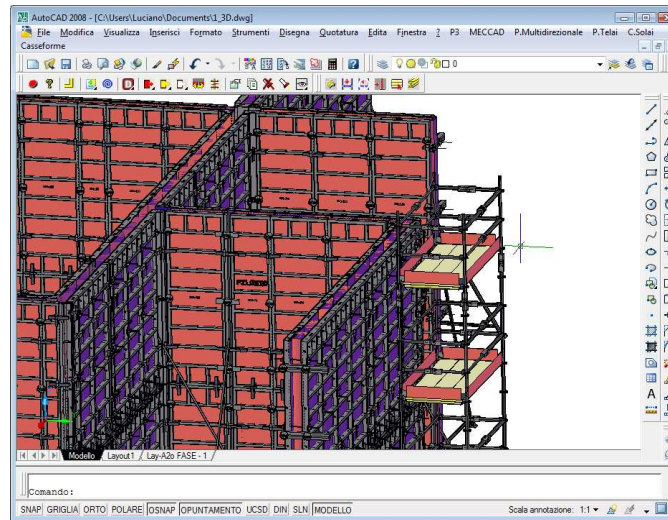

MEC CAD s.r.l.
33100 Udine Italy

info@ponteggicad.it
www.ponteggicad.it
www.meccad.eu
skype: mecc-cad.e xp
tel +39 041 8628992



www.meccad.eu

DEK CAD

**Designing
Floors
System**

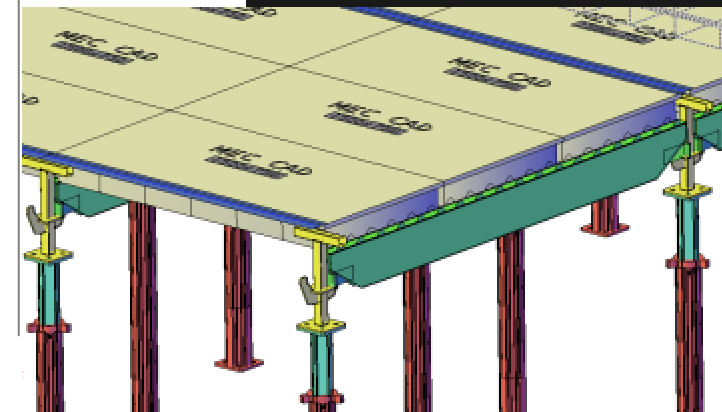

DEK CAD is a professional software to design **Formwork Modular Floors**.

The program is created to have, in **quickly and easily** way, the best solution for the use of formwork for floor slabs.

DEK CAD allows a drastic reduction in design time and the precise drafting of:

- drawings,
- BOM items,
- assembly drawings,
- quotations for sale and rental.

The sw handles the work phases with lists and drawings.

DEK CAD is a plug-in that works within a standard CAD for which:

- hat no limits to design solutions
- the designs are standard DWG
- it's possible to take advantage of existing plans and drawings

The supported CAD are:

- **AUTOCAD**® ver. 2006 or higher
- **BricsCAD**® ver. 9.0 or higher

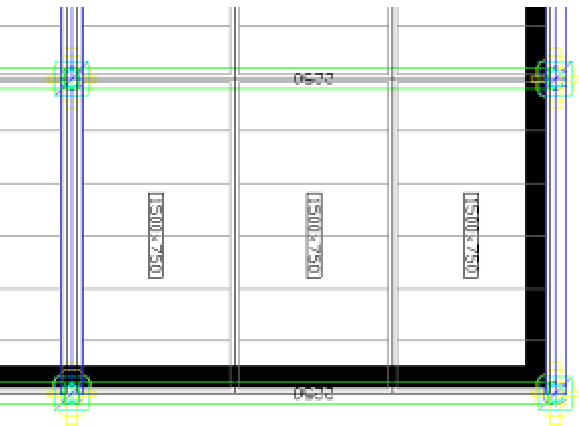

THE DESIGNER DRAWS IN 2D

DEK CAD performs design and drawing by using the simple two-dimensional 2D environment and the transition to the three-dimensional is fully automatic.

This solution, optimized and extreme easy to use, allows you to increment productivity and quality of the design.

At any time the designer can:

- switch from two-dimensional drawing to three-dimensional and vice versa
- act to modify and integrate the proposed application to obtain the best solution
- supplement the designs with your own symbols and method of work

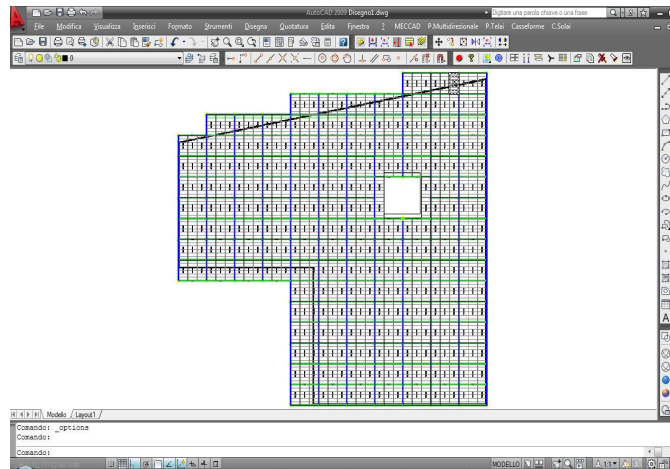

DEK CAD is the ideal tool for the simple, fast and detailed creation of workflow, **from the estimate to the construction executive design**.

The interactive simulation is a special feature that allows you to have the best solution of formwork project, optimizing the use of the amount of material.

DEK CAD is parametric application and can handle any brand and model of formworks varying the measures of panels.

